

# Island Section Exploded

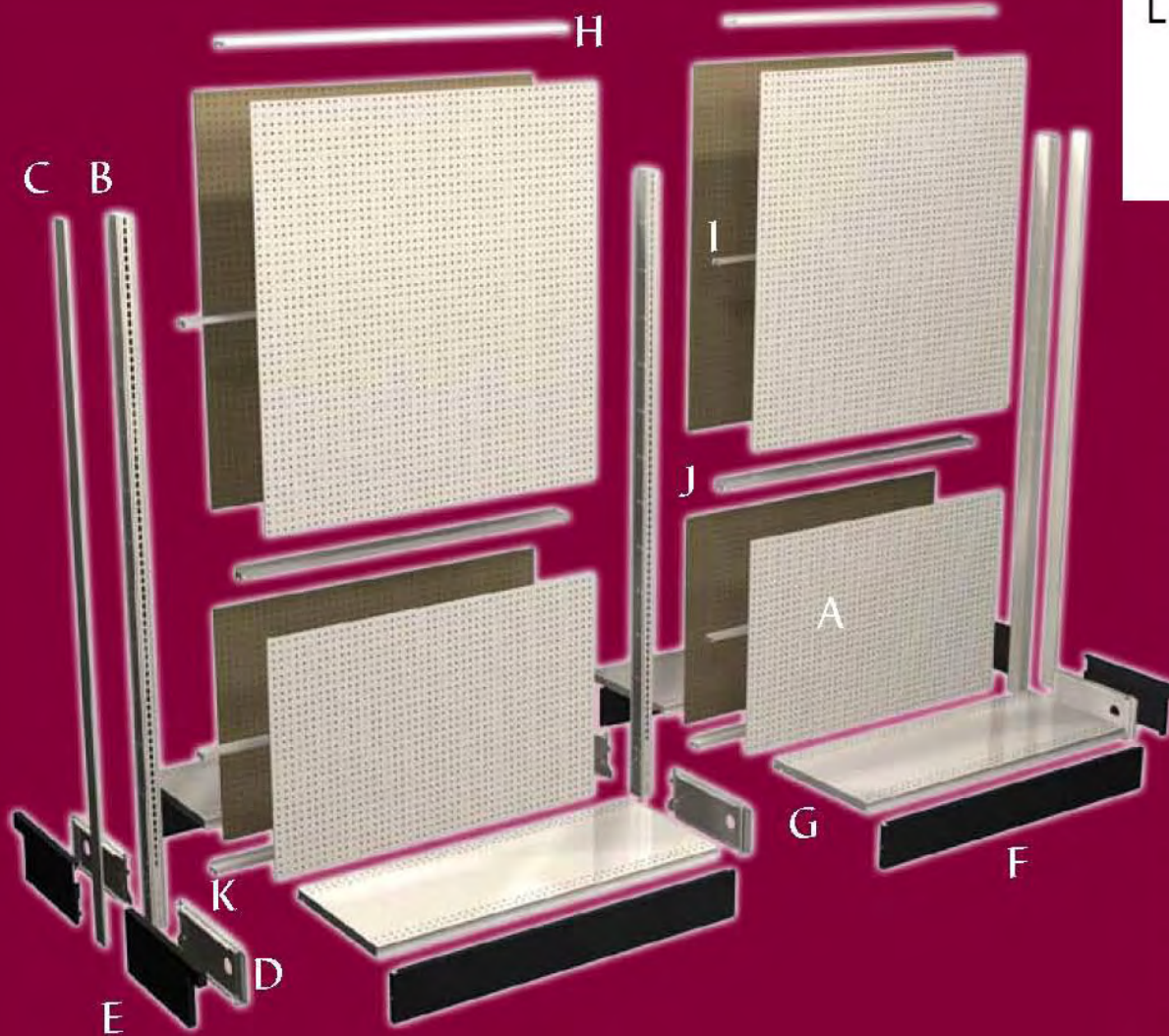

COUNTS		
A		
B		
C		
D		
E		
F		
G		
H		
I		
J		
K		
L		

- Components:**
- |                              |                         |
|------------------------------|-------------------------|
| <u>A</u> = Back              | <u>G</u> = Base Deck    |
| <u>B</u> = Uprite            | <u>H</u> = Top Rail     |
| <u>C</u> = Uprite End Trim   | <u>I</u> = Center Rail  |
| <u>D</u> = Base Brackets     | <u>J</u> = Splicer Rail |
| <u>E</u> = Base End Trim     | <u>K</u> = Bottom Rail  |
| <u>F</u> = Closed Base Front | <u>L</u> = Top Cap      |

# Wall Section Exploded

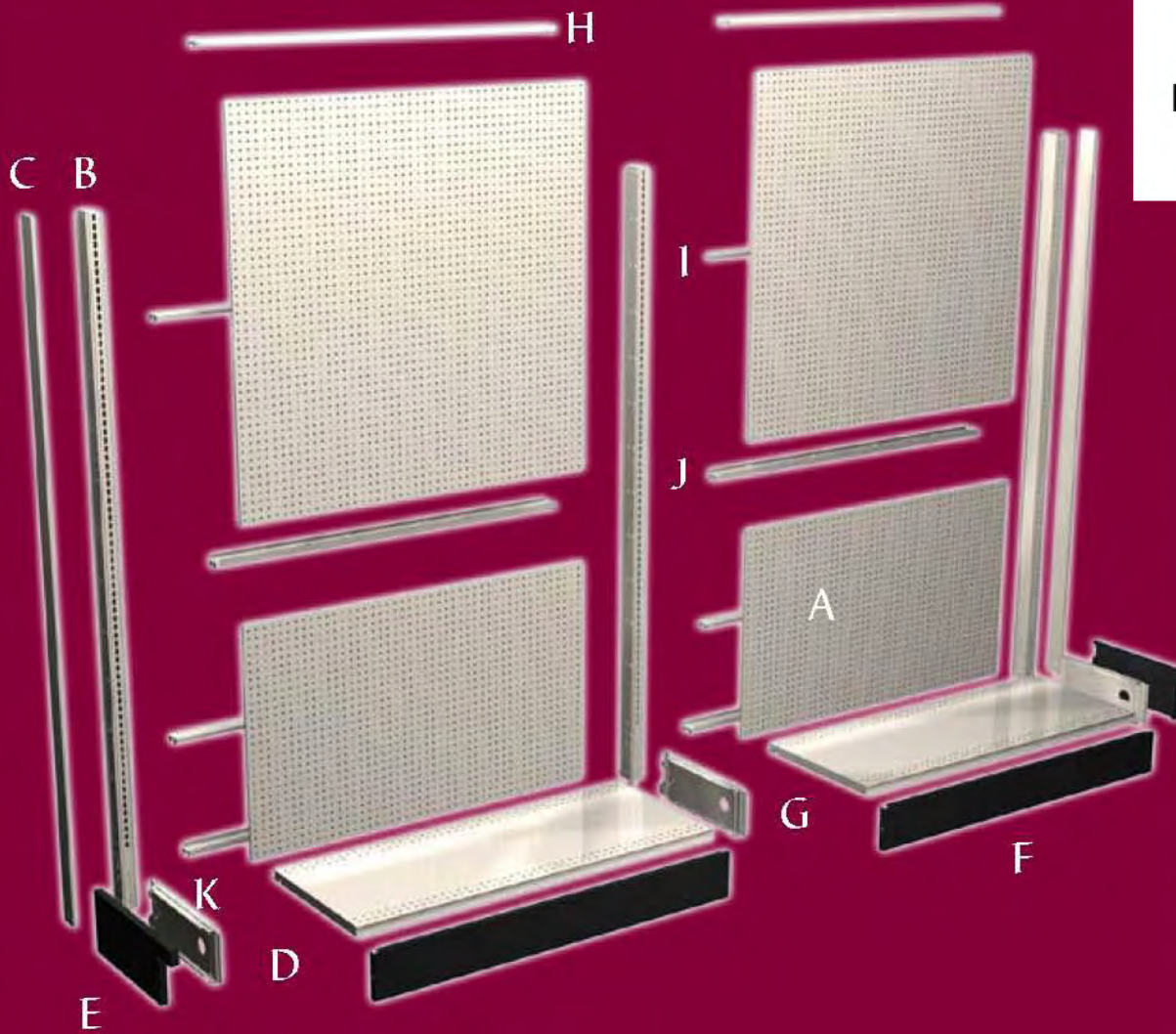

COUNTS		
A		
B		
C		
D		
E		
F		
G		
H		
I		
J		
K		
L		

- Components:**
- A = Back
  - B = Uprite
  - C = Uprite End Trim
  - D = Base Brackets
  - E = Base End Trim
  - F = Closed Base Front
  - G = Base Deck
  - H = Top Rail
  - I = Center Rail
  - J = Splicer Rail
  - K = Bottom Rail
  - L = Top Cap

# Wall & Island Extension Sections

## Extensions & Extension Ends

### Island Extension Section Includes:

- 1 Extension Uprite
- 2 Back material for both sides
- 2 Top Rails (plus 1 Center Rail if 36"H or over)
- **For pricing see section 100, pg 61**

### Wall Extension Section Includes:

- 1 Extension Uprite
- 2 Top Rails (plus 1 Center Rail if 36"H or over)
- 1 Back material, 1 side only
- **For pricing see section 100, pg 61**

### Extension End Includes:

- 1 Extension Uprite
- 2 Uprite End Trims
- **For pricing see section 100, pg 61**

\*\*ONE END REQUIRED FOR ANY LENGTH RUN

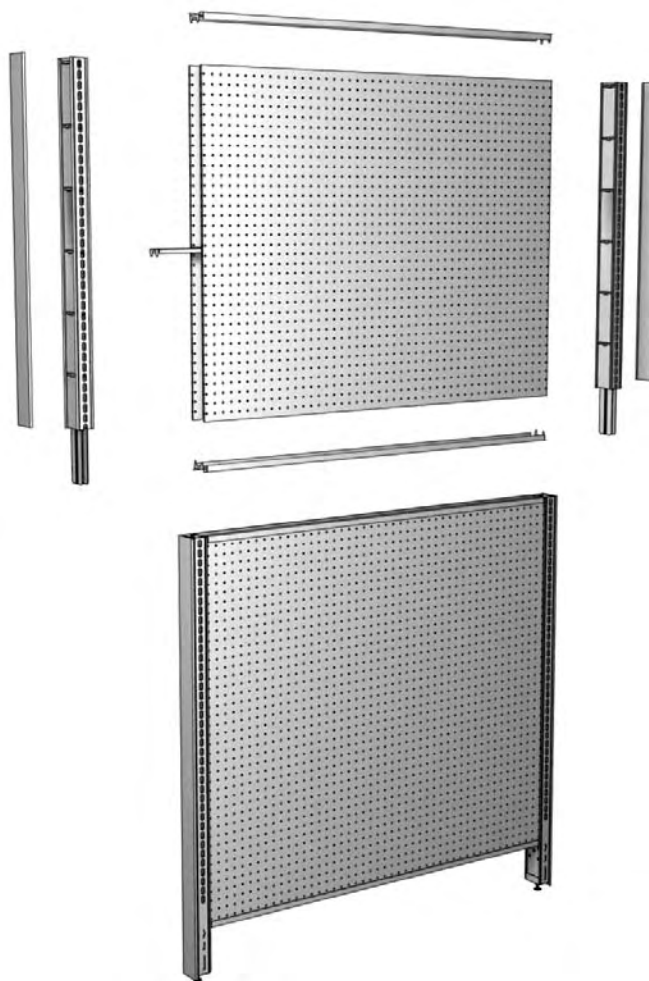

EE	12	E
Extension End		
Height: 6" - 72"		
Extension		

### STANDARD FINISH:

PLT

- Optional Tier I & II colors

(Island Extension shown)

	IS	4	36	E	PLT	PLT	P	PLT	P	PLT
Wall/Island Section (WS or IS)										
Width: 2', 30", 3', 4'										
Height: 6" - 72", 6" increments										
Extension										
Extension Uprite Color										
Rail Color										
Back Style A - (see pg 129)										
Back Color A										
Back Style B (required for IS)										
Back Color B (required for IS)										

# Back Rails - Marteck, Pegboard, Woodgrain

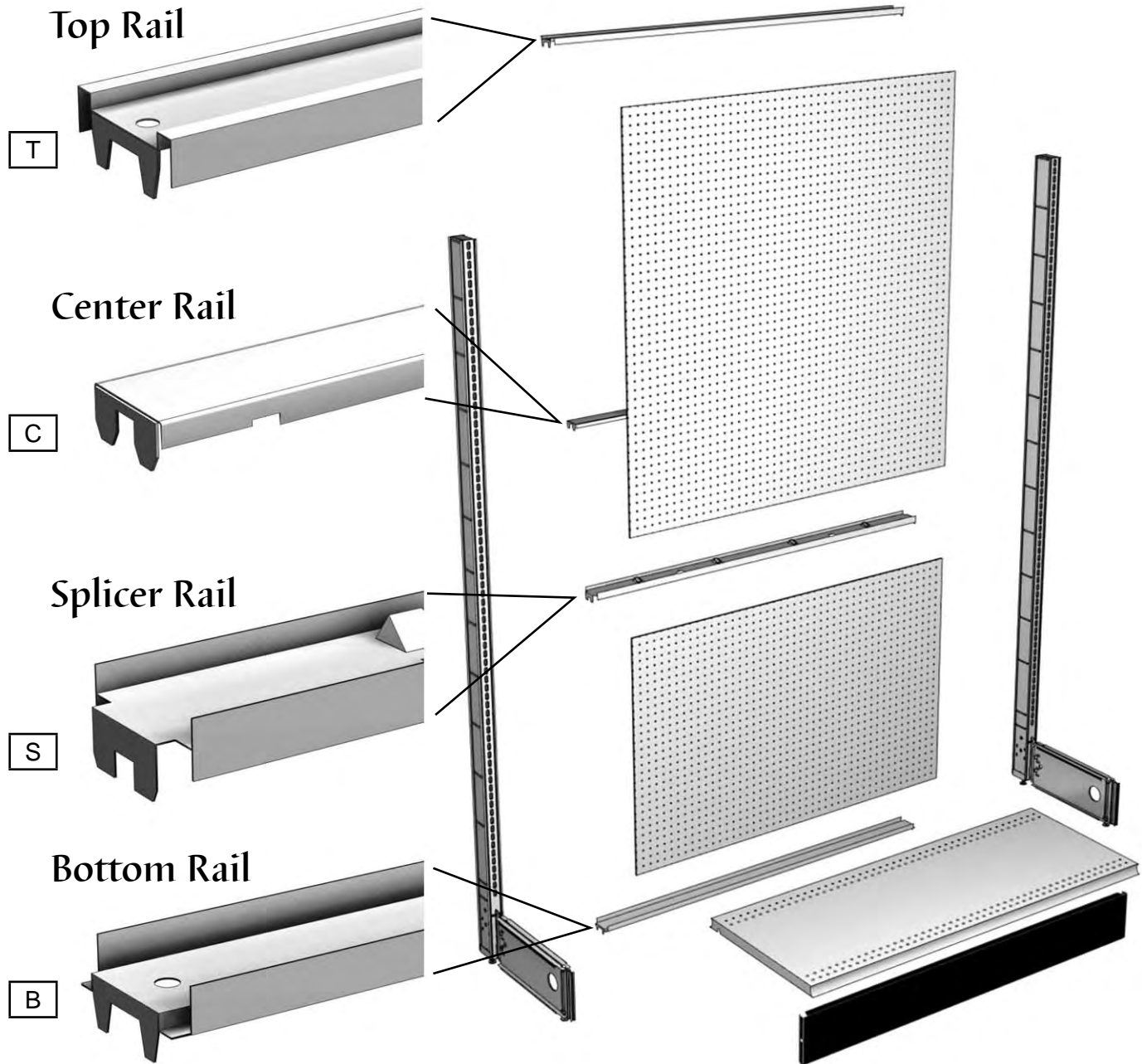

EXAMPLE PART NO.

**R 4 T**

R = Rail  
 4 = Width: 2', 30", 3', 4'  
 T = Rail Style (T, C, S, B)

STANDARD FINISH:

**PLT**

PLT • Top, Bottom & Splicer Rails  
 • Optional Tier I & II colors  
 • Center Rail  
 N/A only

**Rails:**

- All Island and Wall Sections require at least one Top, Center, & Bottom Rail
- 78"H - 120"H require one Splicer Rail
- 96", 108", 120"H require two Center Rails
- Electrical knockouts included on all Rails
- 2' & 30" sections use (2) Top Rails to make a Splicer Rail
- For pricing see section 100, pg 77

RAIL	WIDTH			
	2'	30"	3'	4'
Top				
Center				
Splicer	N/A	N/A		
Bottom				

# Back Rails - Slotwall

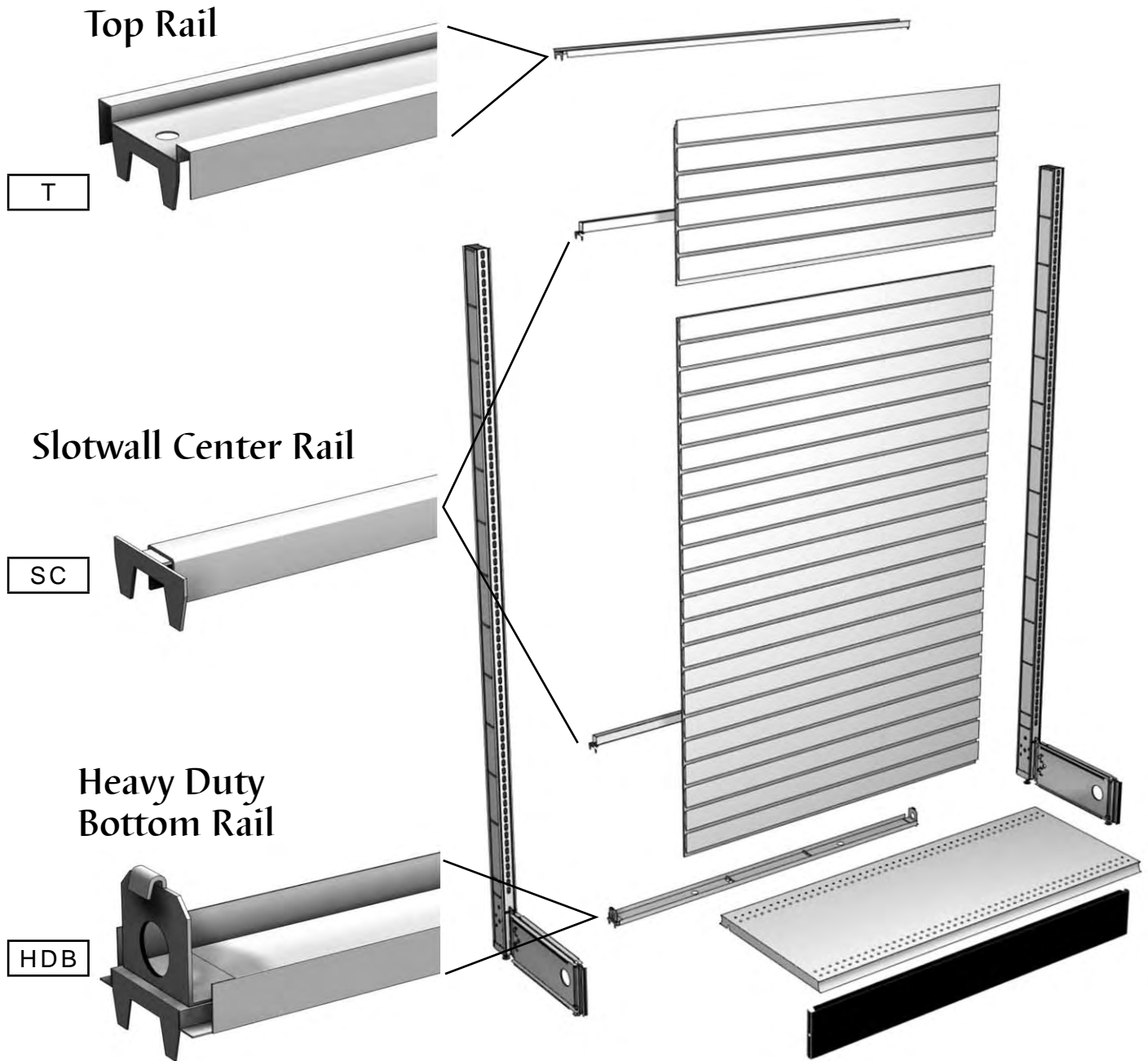

## EXAMPLE PART NO.

**R 4 T**

R = Rail  
 4 = Width: 2', 3', 4'  
 T = Rail Style (T, SC, HDB)

## STANDARD FINISH:

**PLT**

PLT • Top & Bottom Rails  
 • Optional Tier I & II colors  
 • R\_SC PLT only

## Rails:

- Slotwall Island & Wall Sections require at least one Top, Slotwall Center, and Heavy Duty Bottom Rail
- One Slotwall Center Rail for 36" - 66"H Uprites  
Two for 72" - 120"H Uprites
- On Extension Uprites use one Slotwall Center Rail 12" - 60"H & two on 66" - 72"H
- For 2' section use regular duty Bottom Rail
- **For pricing see section 100, pg 77**

RAIL	WIDTH		
	2'	3'	4'
Top			
Center			
Heavy Duty Bottom	N/A		

# Back Rails - Slotwall w/Hardboard Backs

## Top Rail

T



## Hardboard Back Support Clip

(hooks over Slotwall Center Rail)

HBSC

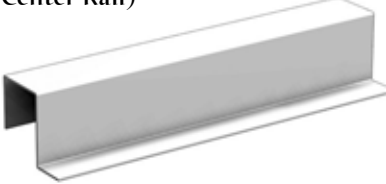

## Half Splicer Rail

HS

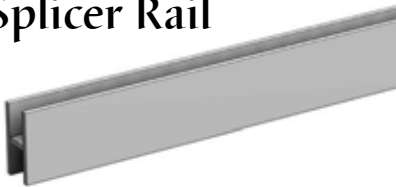

## Slotwall Center Rail

SC



## Heavy Duty Bottom Rail

HDB

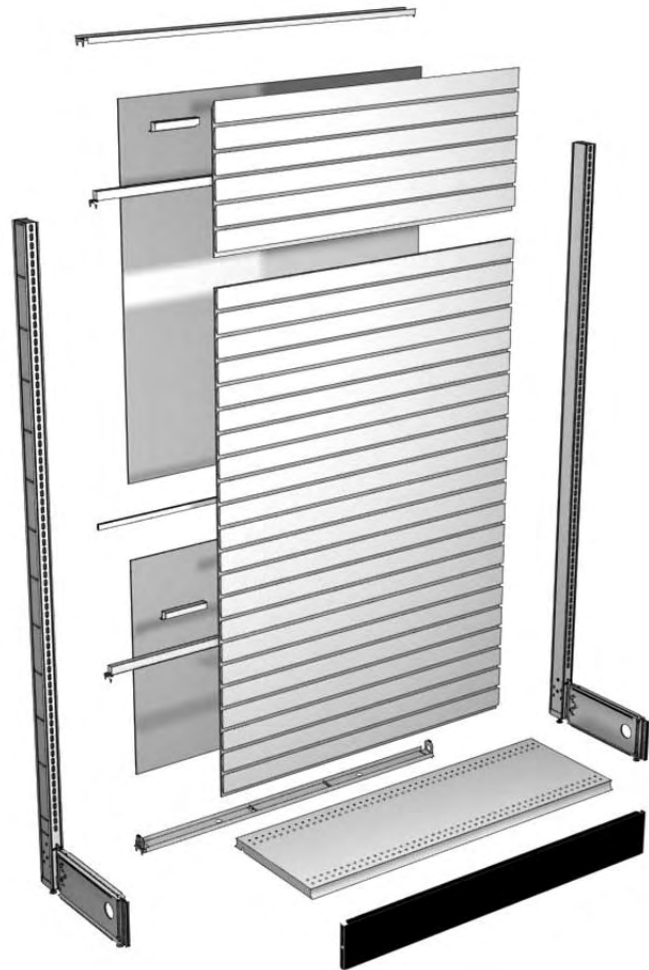
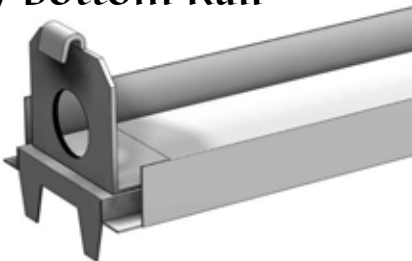

RAIL	WIDTH		
	2'	3'	4'
Top			
Half Splicer			
Center			
Heavy Duty Bottom	N/A		

EXAMPLE PART NO.

STANDARD FINISH:

R 4 T

PLT

R = Rail

PLT

4 = Width: 2', 3', 4'

T = Rail Style:

(T, HS, SC, HDB)

• Top, Half Splicer, & Bottom Rails

• Optional Tier I & II colors

• R\_SC PLT only

EXAMPLE PART NO.

STANDARD FINISH:

HBSC

GLV

HBSC = Hardboard Back Support Clip

• Galvanized

### Rails:

- Slotwall w/Hardboard Island & Wall Sections require at least one Top, Slotwall Center, Hardboard Back Support Clip, and Heavy Duty Bottom Rail
- 36" - 66"H Uprite requires:  
1 center rail & 1 support clip
- 72" - 120"H Uprite requires:  
2 center rail & 2 support clip, & 1 half splicer
- On Extension Uprites, use one Slotwall Center Rail on 12" - 60"H & two on 66" - 72"H
- Electrical knockouts included on Top Rails
- For 2' section use regular duty Bottom Rail
- **For pricing see section 100, pg 77**

# Back Information

## SECTION HEIGHTS: 36" - 72" USE ONE-PIECE BACKS

- 36" = BE-30
- 42" = BE-36
- 48" = BE-42
- 54" = BE-48
- 60" = BE-54
- 66" = BE-60
- 72" = BE-66

## SECTION HEIGHTS: 78" - 120" USE TWO-PIECE BACKS

- 78" = BE-36 + BE-36
- 84" = BE-30 + BE-48
- 90" = BE-36 + BE-48
- 96" = BE-42 + BE-48
- 108" = BE-66 + BE-36
- 120" = BE-66 + BE-48

Wall or Island Back Height		
Nominal Width: 2', 30", 3', or 4'		
Upright Ht.	Nominal Back Ht.	Actual Height
36"	30"	29 13/16"
42"	36"	35 13/16"
48"	42"	41 13/16"
54"	48"	47 13/16"
60"	54"	53 13/16"
66"	60"	59 13/16"
72"	66"	65 13/16"

\* Upright height - 6" = Nominal Back height

Extension Upright Back Height	
Nominal Width: 2', 30", 3', or 4'	
Extension Upright Ht.	Actual Height
6"	5 13/16"
12"	11 13/16"
18"	17 13/16"
24"	23 13/16"
30"	29 13/16"
36"	35 13/16"
42"	41 13/16"
48"	47 13/16"
54"	53 13/16"
60"	59 13/16"
66"	65 13/16"
72"	71 13/16"

\* Extension Upright height = Nominal Back height

### EXAMPLE PART NO.

BE	4	42	P
----	---	----	---

### Standard Finish

- See pg 129

BE = Back

4 = Width: 2', 30", 3', or 4'

42 = Nominal Back height: 6", 12", 18", 24", 30", 36", 42", 48", 54", 60", 66", 72"

P = Back Panel Style: P, M, ME, W, PW, PM

### Actual width of Backs:

- 2' = 22 9/16"
- 30" = 28 9/16"
- 3' = 34 9/16"
- 4' = 46 9/16"

### 4' x 8' Sheet

### EXAMPLE PART NO.

BM4X8	P
-------	---

### Standard Finish

- See pg 129

BM4X8 = Full 4' x 8' sheet

P = Back options:

P, M, PW, PM, W, S, SI